



OPTIMASS 7000

Technical Datasheet

Sensor for mass flow

- The optimum meter for demanding applications
- A single straight measuring tube
- Choice of 3 tube materials
- Low pressure loss
- For applications with high viscosity products
- Secondary pressure containment



The superior solution

OPTIMASS 7000 is the only sensor for mass flow with a straight measuring tube that is available in Hastelloy®, titanium or stainless steel. OPTIMASS 7000 reliably measures mass flow, density, volume, temperature, mass or volume concentration as well as solids content.



- ① Comprehensive diagnosis capabilities
- ② All standard process connections available, including hygienic type connections
- ③ Same electronics for all sensors with redundant storage of calibration and sensor data
- ④ Modular electronics with all output options, see separate data sheet for details

Highlights

- Secondary pressure containment around sensor
- Easily drained and easy to clean
- Regardless of type of installation and external factors
- Excellent zero stability
- Low energy consumption, low operating and installation costs
- Rapid signal processing even with product and temperature changes and sudden changes in density
- Modular electronics concept: electronics and sensor easy to replace
- Data redundancy: accurate plug & play replacement of electronics

Industries

- Wastewater
- Mining & Building Materials
- Chemical
- Iron, Steel & Metal
- Food & Beverage
- Oil & Gas
- Paper & Pulp
- Petrochemistry
- Pharmaceutical
- Water

Applications

- Viscous or shear-sensitive products
- Products requiring low flow velocities
- Inhomogeneous mixtures
- Products with entrained solids or gas

Mass flowmeter product family

All meters consist of a sensor and a converter, which may be mounted integral to the sensor, or remotely, either with a field mount kit, a wall mount housing or a 19" rack mount module.

A sensor mount converter (MFC 010) with a Modbus[®] output only is also possible for OEM manufacturers or where the user does not require a converter with analogue outputs.

Converter: Common hardware for all converters makes spares holding simpler



- ❶ MFC 300 C: Compact or integrally mounted on sensor
- ❷ MFC 300 F: Field mount up to 300 m / 1000 ft from sensor
- ❸ MFC 300 W: Wall mount for non-hazardous areas
- ❹ MFC 300 R: 19" Rack mount module for control room installation
- ❺ MFC 010: Sensor electronics with Modbus[®] output

Sensor: Sensors for any applications



- ❶ OPTIMASS 1000: The general purpose solution for the process industry
- ❷ OPTIMASS 3000: The meter for low flow applications
- ❸ OPTIMASS 7000: The optimum solution for the chemical, food & beverage and pharmaceutical industry
- ❹ OPTIMASS 8000: The meter for high pressure and elevated temperatures
- ❺ OPTIMASS 9000: The high temperature solution up to 350°C / 660°F

Technical Data

Titanium versions:

Operating data

Size	T06	T10	T15	T25	T40	T50	T80
------	-----	-----	-----	-----	-----	-----	-----

Flow rate

Nominal flow rate [kg/h]	950	2700	11250	34500	91500	180000	430000
Nominal flow rate [lbs/min]	35	100	400	1250	3300	6600	15800
Maximum flow rate	130% of nominal flow rate						
Minimum flow rate	Depending on measuring error required						

Accuracy

Accuracy, liquid	±0.1% of actual measured flow rate
Accuracy, gas	±0.5% of actual measured flow rate
Repeatability	Better than 0.05% plus zero stability (includes the combined effects of repeatability, linearity and hysteresis)
Zero stability	±0.008% of nominal flow rate with respective sensor size

Reference conditions

Product	Water
Temperature	20°C / 68°F
Operating pressure	1 bar _{rel.} / 14.5 psig

Density

Measuring range	500...2000 kg/m ³ / 30...125 lbs/ft ³
Accuracy	±2 kg/m ³ / ±0.13 lbs/ft ³
Accuracy (on-site calibration)	±0.5 kg/m ³ / ±0.033 lbs/ft ³

Temperature

Measuring range	-40...+150°C / -40...+302°F
Accuracy	±1°C / ±1.8°F

Device specifications

Size	T06	T10	T15	T25	T40	T50	T80
------	-----	-----	-----	-----	-----	-----	-----

Materials

Measuring tube	Titanium
Flange raised face	Titanium
Flanges	Stainless steel 1.4435 / AISI 316L
Outer cylinder (secondary pressure containment)	Stainless steel 1.4301 / AISI 304 (optional: stainless steel 1.4435 / AISI 316L)
Sensor electronics housing	Stainless steel 1.4435 / AISI 316L

Nominal pressure at 20°C or 68°F

Measuring tube	-1...100 bar _{rel.} / -14.5...1450 psig
Outer cylinder (secondary pressure containment)	Standard: -1...63 bar _{rel.} / -14.5...910 psig; Optional: -1...100 bar _{rel.} / -14.5...1450 psig

Temperature

Process temperature - flanged connections	-40...+150°C / -40...+302°F
Process temperature - hygienic type connections	-20...+150°C / -4...+302°F
Ambient temperature - compact version	-40...+55°C / -40...+130°F
Ambient temperature - remote version	-40...+60°C / -40...+140°F

Process effects on the sensor

Temperature	0.002% of the nominal flow rate per 1°C / 0.001% of the nominal flow rate per 1°F
Pressure	0.015% of the nominal flow rate per 1 bar _{rel.} / 0.001% of the nominal flow rate per 1 psig

Hastelloy® versions:

Operating data

Size	H10	H15	H25	H40	H50	H80
------	-----	-----	-----	-----	-----	-----

Flow rate

Nominal flow rate [kg/h]	2700	11250	34500	91500	180000	430000
Nominal flow rate [lbs/min]	100	400	1250	3300	6600	15800
Maximum flow rate	130% of nominal flow rate					
Minimum flow rate	Depending on measuring error required					

Accuracy

Accuracy, liquid	±0.1% of actual measured flow rate
Accuracy, gas	±0.5% of actual measured flow rate
Repeatability	Better than 0.05% plus zero stability (includes the combined effects of repeatability, linearity and hysteresis)
Zero stability	±0.05% of nominal flow rate with respective sensor size

Reference conditions

Product	Water
Temperature	20°C / 68°F
Operating pressure	1 bar _{rel.} / 14.5 psig

Density

Measuring range	500...2000 kg/m ³ / 30...125 lbs/ft ³
Accuracy	±2 kg/m ³ / ±0.13 lbs/ft ³
Accuracy (on-site calibration)	±0.5 kg/m ³ / ±0.033 lbs/ft ³

Temperature

Measuring range	0...+100°C / +32...+210°F
Accuracy	±1°C / ±1.8°F

Device specifications

Size	H10	H15	H25	H40	H50	H80
------	-----	-----	-----	-----	-----	-----

Materials

Measuring tube	Hastelloy® C-22
Flange raised face	Hastelloy® C-22
Flanges	Stainless steel 1.4435 / AISI 316L (optional: HC-22)
Outer cylinder (secondary pressure containment)	Stainless steel 1.4301 / AISI 304 (optional: stainless steel 1.4435 / AISI 316L)
Sensor electronics housing	Stainless steel 1.4435 / AISI 316L

Nominal pressure at 20°C or 68°F

Measuring tube	-1...40 bar _{rel.} / -14.5...580 psig
Outer cylinder (secondary pressure containment)	-1...63 bar _{rel.} / -14.5...910 psig

Temperature

Process temperature - flanged connections	0...+100°C / +32...+210°F
Ambient temperature - compact version	-40...+55°C / -40...+130°F
Ambient temperature - remote version	-40...+60°C / -40...+140°F

Process effects on the sensor

Temperature	0.0075% of the nominal flow rate per 1°C / 0.0042% of the nominal flow rate per 1°F
Pressure	0.015% of the nominal flow rate per 1 bar _{rel.} / 0.001% of the nominal flow rate per 1 psig

Stainless steel versions:
Operating data

Size	S06	S10	S15	S25	S40	S50	S80
------	-----	-----	-----	-----	-----	-----	-----

Flow rate

Nominal flow rate [kg/h]	950	2700	11250	34500	91500	180000	430000
Nominal flow rate [lbs/min]	35	100	400	1250	3300	6600	15800
Maximum flow rate	130% of nominal flow rate						
Minimum flow rate	Depending on measuring error required						

Accuracy

Accuracy, liquid	±0.1% of actual measured flow rate
Accuracy, gas	±0.5% of actual measured flow rate
Repeatability	Better than 0.05% plus zero stability (includes the combined effects of repeatability, linearity and hysteresis)
Zero stability	±0.05% of nominal flow rate with respective sensor size

Reference conditions

Product	Water
Temperature	20°C / 68°F
Operating pressure	1 bar _{rel.} / 14.5 psig

Density

Measuring range	500...2000 kg/m ³ / 30...125 lbs/ft ³
Accuracy	±2 kg/m ³ / ±0.13 lbs/ft ³
Accuracy (on-site calibration)	±0.5 kg/m ³ / ±0.033 lbs/ft ³

Temperature

Measuring range - flanged connections	0...+100°C / +32...+210°F	
Measuring range - hygienic type connections	0...+100°C / +32...+210°F	0...+130°C / +32...+265°F
Accuracy	±1°C / ±1.8°F	

Device specifications

Size	S06	S10	S15	S25	S40	S50	S80
------	-----	-----	-----	-----	-----	-----	-----

Materials

Measuring tube	Stainless steel 1.4462 / AISI 318L
Flange raised face	Stainless steel 1.4462 / AISI 318L
Flanges	Stainless steel 1.4435 / AISI 316L
Outer cylinder (secondary pressure containment)	Stainless steel 1.4301 / AISI 304 (optional: stainless steel 1.4435 / AISI 316L)
Sensor electronics housing	Stainless steel 1.4435 / AISI 316L

Nominal pressure at 20°C or 68°F

Measuring tube	-1...40 bar _{rel.} / -14.5...580 psig
Outer cylinder (secondary pressure containment)	-1...63 bar _{rel.} / -14.5...910 psig

Temperature

Process temperature	0...+100°C / +32...+210°F	0...+130°C / +32...+265°F (with hygienic type connections)
Ambient temperature - compact version	-40...+55°C / -40...+130°F	
Ambient temperature - remote version	-40...+60°C / -40...+140°F	

Process effects on the sensor

Temperature	0.0075% of the nominal flow rate per 1°C / 0.0042% of the nominal flow rate per 1°F
Pressure	0.015% of the nominal flow rate per 1 bar _{rel.} / 0.001% of the nominal flow rate per 1 psig

Approvals

Size	S / H / T06	S / H / T10	S / H / T15	S / H / T25	S / H / T40	S / H / T80
------	-------------	-------------	-------------	-------------	-------------	-------------

Mechanical

Protection category (acc. to EN 60529)	IP 67; NEMA 4X
European Pressure Equipment directive	PED 97-23 EC (acc. to AD 2000 Regelwerk)

ATEX (acc. to 94/9/EC)

OPTIMASS 7300 C - With "flameproof" terminal compartment	II 2 G EEx d ib IIC T6...T1
	II 2 D Ex tD A21 IP6x T175°C
	II 2(1) G EEx d ib[ia] IIC T6...T1
	II 2(1) D Ex tD [iaD] A21 IP6x T175°C
OPTIMASS 7300 C - With "increased safety" terminal compartment	II 2 G EEx de ib IIC T6...T1
	II 2 D Ex tD A21 IP6x T175°C
	II 2(1) G EEx de ib[ia] IIC T6...T1
	II 2(1) D Ex tD [iaD] A21 IP6x T175°C
OPTIMASS 7000 and 7010 C	II 2 G EEx ib IIC T6...T1
	II 2 D Ex ibD 21 T165°C
MFC 300 F- With "flameproof" terminal compartment	II 2(1) G EEx d [ia] IIC T6
	II 2(1) D Ex tD [iaD] A21 IP6x T85°C
MFC 300 F- With "increased safety" terminal compartment	II 2(1) G EEx de [ia] IIC T6
	II 2(1) D Ex tD [iaD] A21 IP6x T85°C
Factory Mutual / CSA	Class I, Div 1 groups A, B, C, D
	Class II, Div 1 groups E,F,G
	Class III, Div 1 hazardous areas
	Class I, Div 2 groups A, B, C, D
	Class II, Div 2 groups F,G
	Class III, Div 2 hazardous areas

Electromagnetic compatibility (EMC)

to CE	EN 50081-1 (1992); EN 50082-2 (1994);
	Namur NE 21/5.95;
	89/336/EEC (EMC);
	72/73/EEC (Low Voltage Directive)

Dimensions

Flanged version

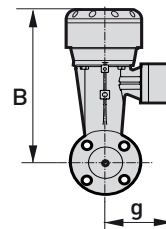
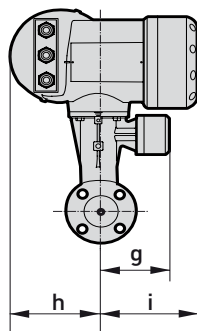
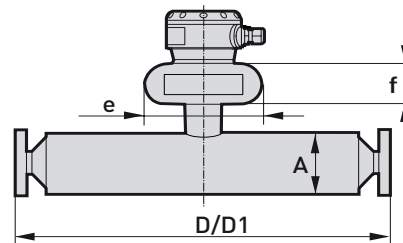
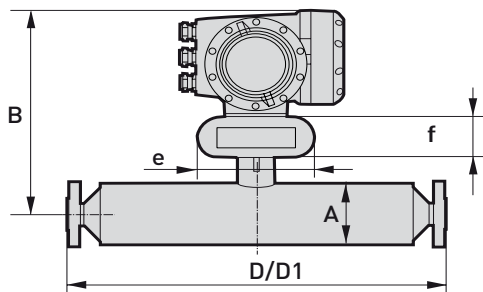

①

②

- ① Compact version
- ② Remote version

Dimensions in mm

Dimensions [mm]	Size						
	T06 / S06	T10 / H10 / S10	T15 / H15 / S15	T25 / H25 / S25	T40 / H40 / S40	T50 / H50 / S50	T80 / H80 / S80
A	102			115	170	220	274
B (compact)	311			318	345	370	397
B (remote)	231±2			237±2	265±2	290±2	317±4
D (standard flange)	420±2	510±2	548±2	700±2	925±2	1101±2	1460±4
D1 (ASME flange 600 lbs)	428±2	518±2	556±2	708±2	933±2	1109±2	1468±4
e	160						
f	60						
g	98.5						
h	123.5						
i	137						

Dimensions in inches

Dimensions [inches]	Size						
	T06 / S06	T10 / H10 / S10	T15 / H15 / S15	T25 / H25 / S25	T40 / H40 / S40	T50 / H50 / S50	T80 / H80 / S80
A	4			4,5	6,7	8,7	10,8
B (compact)	12.2			12,5	13,6	14,6	15,6
B (remote)	9.1±0.08			9.3±0.08	10.4±0.08	11.4±0.08	12.5±0.16
D (standard flange)	16.5±0.08	20.1±0.08	21.6±0.08	27.6±0.08	36.4±0.08	43.3±0.08	57.5±0.16
D1 (ASME flange 600 lbs)	16.9±0.08	20.4±0.08	21.9±0.08	27.9±0.08	36.7±0.08	43.7±0.08	57.8±0.16
e	6.3						
f	2.4						
g	3.9						
h	4.9						
i	5.4						

Hygienic version

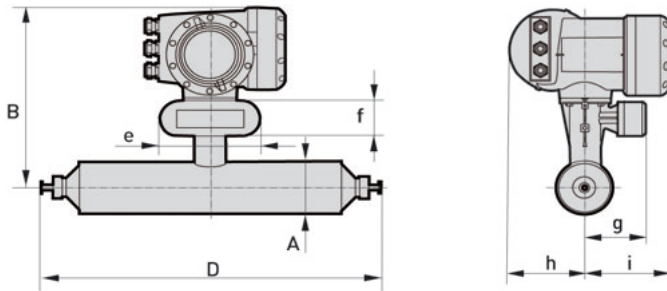

Dimensions in mm

Dimensions [mm]	Size						
	T06 / S06	T10 / H10 / S10	T15 / H15 / S15	T25 / H25 / S25	T40 / H40 / S40	T50 / H50 / S50	T80 / H80 / S80
A	102			115	170	220	274
B	311			318	345	370	397
e	160						
f	60						
g	98.5						
h	123.5						
i	137						

Dimensions in inches

Dimensions [inches]	Size						
	T06 / S06	T10 / H10 / S10	T15 / H15 / S15	T25 / H25 / S25	T40 / H40 / S40	T50 / H50 / S50	T80 / H80 / S80
A	4			4.5	6.7	8.7	10.8
B	12.2			12.5	13.6	14.6	15.6
e	6.3						
f	2.4						
g	3.9						
h	4.9						
i	5.4						

Hygienic type connections: all-welded versions

Size	Tri-Clover	D [mm]	TriClamp DIN 32676	D [mm]	TriClamp ISO 2852	D [mm]	Tongue and groove flange DIN 11864	D [mm]
6	½"	480±2	DN10	484±2	-	-	-	-
10	½"	558±2	DN10	564±2	-	-	DN10	528±2
15	¾"	596±2	DN15	602±2	-	-	DN15	566±2
25	1½"	816±2	DN25	761±2	1½"	816±2	DN25	718±2
40	2"	1043±2	DN40	986±2	2"	1043±2	DN40	948±2
50	3"	1305±2	DN50	1168±2	3"	1305±2	DN50	1124±2
80	4"	1527±2	DN80	1584±2	4"	1527±2	DN80	1538±2

Hygienic type connections: adapter versions

Size	Tri-Clover	D [mm]	TriClamp DIN 32676	D [mm]	TriClamp ISO 2852	D [mm]
6	-	-	-	-	-	-
10	½"	597±2	DN10	590±2	-	-
15	¾"	635±2	DN15	628±2	-	-
15	1"	665±2	-	-	1"	665±2
25	1½"	855±2	DN25	787±2	1½"	855±2
40	2"	1077±2	DN40	1017±2	2"	1077±2
50	3"	1355±2	DN50	1193±2	3"	1355±2
80	-	-	-	-	-	-

Hygienic type connections: adapter versions

Size	Male thread DIN 11851	D [mm]	Male thread SMS	D [mm]	Male thread IDF/ISS	D [mm]	Male thread RJT	D [mm]
6	-	-	-	-	-	-	-	-
10	DN10	596±2	-	-	-	-	-	-
15	DN15	634±2	-	-	-	-	-	-
15	-	-	1"	665±2	1"	664±2	1"	676±2
25	DN25	802±2	1½"	852±2	1½"	854±2	1½"	866±2
40	DN40	1040±2	2"	1074±2	2"	1076±2	2"	1088±2
50	DN50	1220±2	3"	1360±2	3"	1354±2	3"	1366±2
80	DN80	1658±2	-	-	-	-	-	-

Version with heating jacket

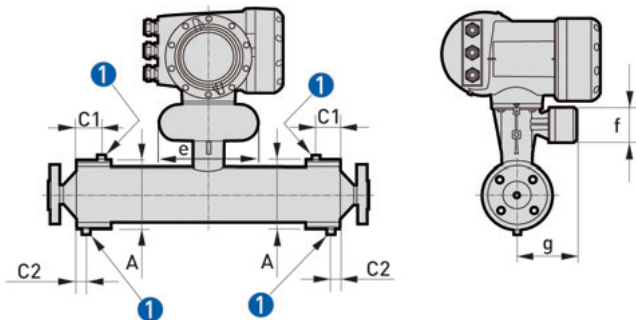

1 Connection

Dimensions in mm

Dimensions [mm]	Size						
	T10 / H10 / S10	T15 / H15 / S15	T25 / H25 / S25	T40 / H40 / S40	T50 / H50 / S50	T80 / H80 / S80	
Connection size	12				25		
A	115±1		142±1	206±1	254±1		305±1
B	311		318	345	370		397
C1 (T)	36±1	51±1	100±1	130±1	180±1	175±2	385±2
C2 (T)	20				26±1		
C1 (H & S)	-	51±1	55±1	130±1	105±1	100±2	200±2
C2 (H & S)	-	20			26±1		
e	160						
f	60						
g	98.5						

Dimensions in inches

Dimensions [inches]	Size						
	T10 / H10 / S10	T15 / H15 / S15	T25 / H25 / S25	T40 / H40 / S40	T50 / H50 / S50	T80 / H80 / S80	
Connection size	½				1		
A	4.5±1		5.6±1	8.1±1	10±1		12±1
B	12.2		12.5	13.6	14.6		15.6
C1 (T)	1.4±0.08	2±0.08	3.9±0.08	5.1±0.08	7.1±0.08	6.9±0.16	15.2±0.16
C2 (T)	0.8				1±0.08		
C1 (H & S)	-	2±0.08	2.2±0.08	5.1±0.08	4.1±0.08	3.9±0.16	7.9±0.16
C2 (H & S)	-	0.8			1±0.08		
e	6.3						
f	2.4						
g	3.9						

Version with purge ports

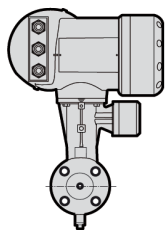
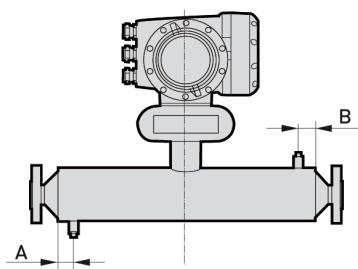

Dimensions in mm

Dimensions [mm]	Size						
	T06 / S06	T10 / H10 / S10	T15 / H15 / S15	T25 / H25 / S25	T40 / H40 / S40	T50 / H50 / S50	T80 / H80 / S80
A	65	30			65		
B	30				65		

Dimensions in inches

Dimensions [inches]	Size						
	T06 / S06	T10 / H10 / S10	T15 / H15 / S15	T25 / H25 / S25	T40 / H40 / S40	T50 / H50 / S50	T80 / H80 / S80
A	2.6	1.2			2.6		
B	1.2				2.6		

Measuring accuracy

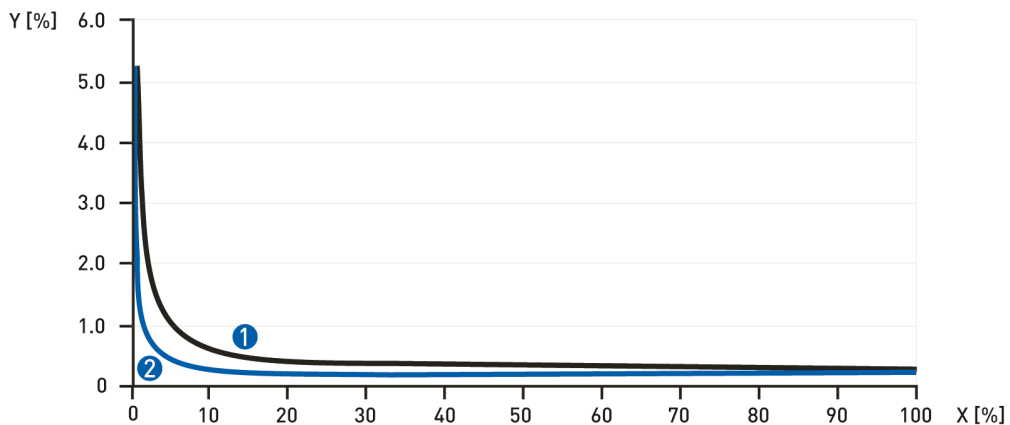

Y[%]: measuring error; X[%] nominal flow rate

- ① Hastelloy® C-22 and stainless steel 318L
- ② Titanium

Measuring error

The measuring error is obtained from the combined effects of accuracy and zero stability.

Full-scale ranges and measuring errors

Full-scale ranges	100 : 1	20 : 1	10 : 1	5 : 1	2 : 1	1 : 1
-------------------	---------	--------	--------	-------	-------	-------

Titanium

Typical measuring error %	0.90	0.26	0.18	0.14	0.12	0.11
---------------------------	------	------	------	------	------	------

Hastelloy® C-22 & stainless steel 318L

Typical measuring error %	5.10	1.10	0.60	0.35	0.20	0.15
---------------------------	------	------	------	------	------	------

Guidelines for maximum operating pressure

Note:

Ensure that the meters are used within their operating limits. Observe the following illustrations.

Flanged connections as per DIN 2501:

Pressure / temperature de-rating for titanium Gr 9 meters

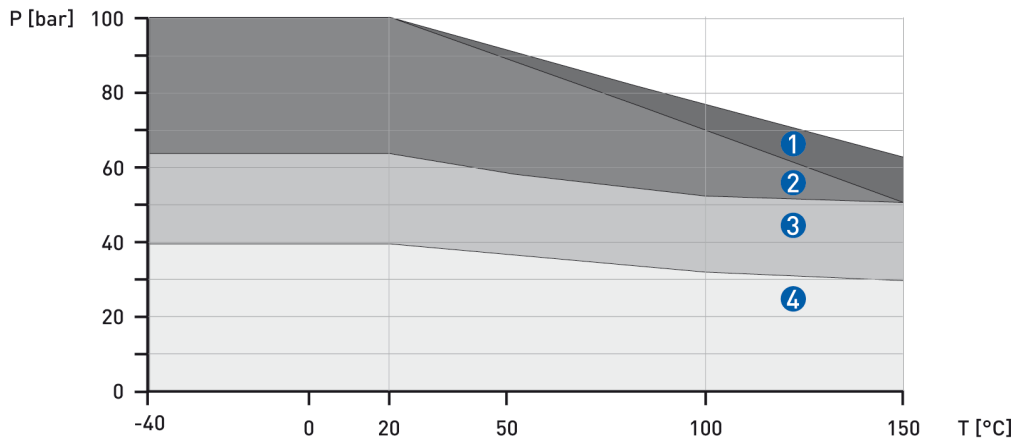

- ① PN100 flanges for sizes T06...T25 and secondary pressure containment PN100
- ② PN100 flanges for sizes T40...T80 and secondary pressure containment PN100
- ③ PN63 flanges for secondary pressure containment PN63
- ④ PN40 flanges

Pressure / temperature de-rating for stainless steel and Hastelloy® C22 meters

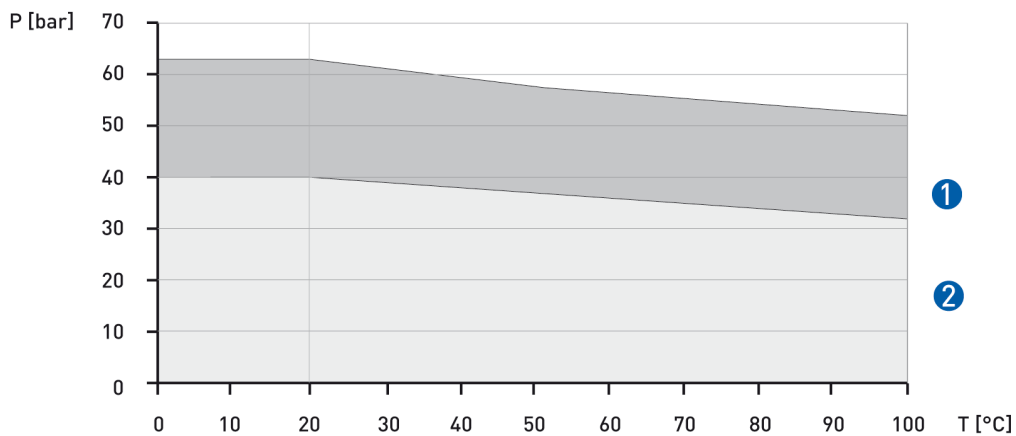

- ① Secondary pressure containment for all sizes
- ② PN40 flanges

Note:

All hygienic type process connections rated to 10 barg / 145 psig at 20°C / 68°F.

**Flanged connections as per ASME:
Pressure / temperature de-rating for titanium Gr 9 meters**

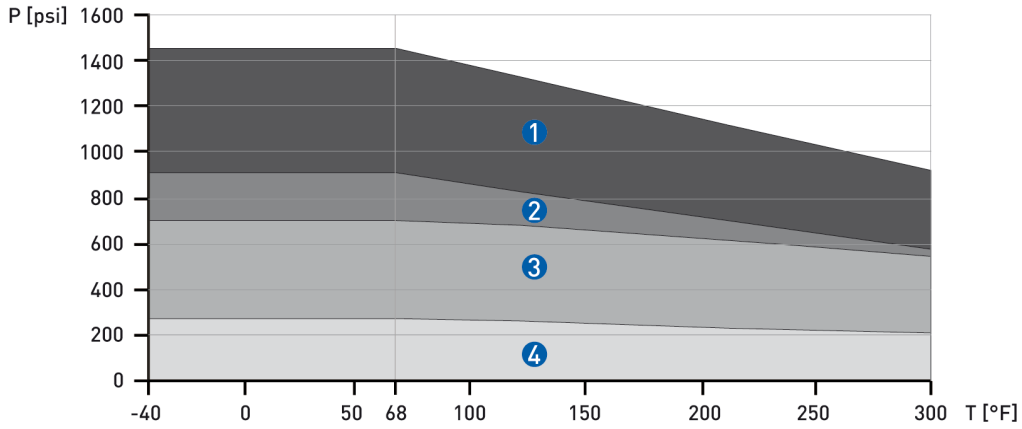

- ① ASME 600 lbs and secondary pressure containment 1450 psi
- ② Secondary pressure containment 910 psi
- ③ ASME 300 lbs
- ④ ASME 150 lbs

Pressure / temperature de-rating for stainless steel and Hastelloy® C22 meters

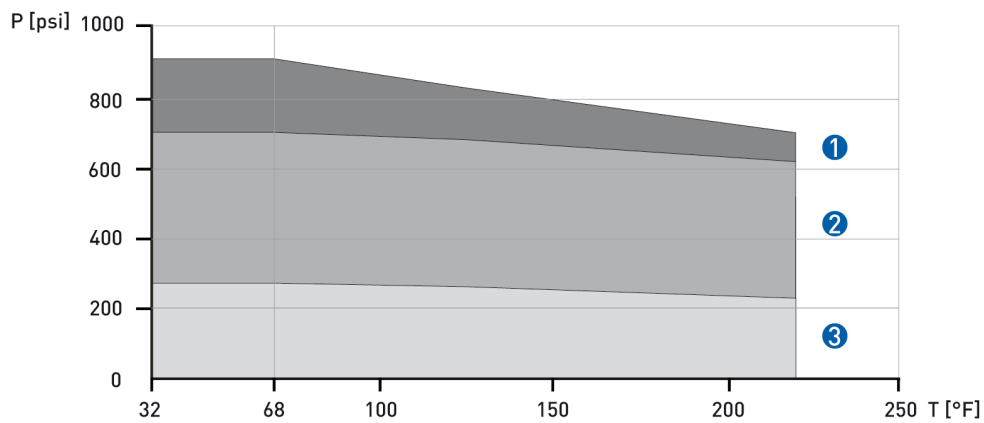

- ① Secondary pressure containment for all sizes
- ② ASME 300 lbs
- ③ ASME 150 lbs

Note:

All hygienic type process connections rated to 10 barg / 145 psig at 20°C / 68°F.



KROHNE Product Overview

- Electromagnetic flowmeters
- Variable area flowmeters
- Mass flowmeters
- Ultrasonic flowmeters
- Vortex flowmeters
- Flow controllers
- Level measuring instruments
- Pressure gauges
- Temperature measuring instruments
- Water solutions & analysis
- Oil and gas turnkey solutions

Addresses:

Germany

Northern sales office

KROHNE Messtechnik GmbH & Co. KG
Bremer Str. 133
D-21073 Hamburg
Phone: +49 [0]40 767 3340
Fax: +49 [0]40 767 33412
nord@krohne.de
ZIP code: 10000 - 29999, 49000 - 49999

Western and middle sales office

KROHNE Messtechnik GmbH & Co. KG
Ludwig-Krohne-Straße
D-47058 Duisburg
Phone: +49 [0]203 301 416
Fax: +49 [0]203 301 10416
west@krohne.de
ZIP code: 30000 - 34999, 37000 - 48000, 50000 - 53999, 57000 - 59999, 98000 - 99999

Southern sales office

KROHNE Messtechnik GmbH & Co. KG
Landsberger Str. 392
D-81241 Munich
Phone: +49 [0]89 121 5620
Fax: +49 [0]89 129 6190
sued@krohne.de
ZIP code: 0 - 9999, 80000 - 89999, 90000 - 97999

Southwestern sales office

KROHNE Messtechnik GmbH & Co. KG
Rüdesheimer Str. 40
D-65239 Hochheim/Main
Phone: +49 [0]6146 827 30
Fax: +49 [0]6146 827 312
rhein-main@krohne.de
ZIP code: 35000 - 36999, 54000 - 56999, 60000 - 79999

Instrumentation and control equipment catalog

TABLAR Messtechnik GmbH
Ludwig-Krohne-Straße 5
D-47058 Duisburg
Phone: +49 [0]2 03 305 880
Fax: +49 [0]2 03 305 888
kontakt@tablar.de www.tablar.de

KROHNE sales companies

International

Australia

KROHNE Australia Pty Ltd
Quantum Business Park 10/287
Victoria Rd Rydalmere NSW 2116
Phone: +61 2 8846 1700
Fax: +61 2 8846 1755
krohne@krohne.com.au

Austria

KROHNE Austria Ges.m.b.H.
Modecenterstraße 14
A-1030 Vienna
Phone: +43 [0]1 203 45 32
Fax: +43 [0]1 203 47 78
info@krohne.at

Belgium

KROHNE Belgium N.V.
Brusselstraat 320
B-1702 Groot Bijgaarden
Phone: +32 [0]2 4 66 00 10
Fax: +32 [0]2 4 66 08 00
krohne@krohne.be

Brazil

KROHNE Conaut Controles
Automaticos Ltda.
Estrada Das Águas Espraiadas, 230
C. P. 56 06835 - 080 EMBU - SP
Phone: +55 [0]11-4785-2700
Fax: +55 [0]11 4785-2768
conaut@conaut.com.br

China

KROHNE Measurement Instruments
[Shanghai] Co. Ltd., (KMIC)
Room 1501
1033 Zhaojiabang Road
Shanghai 200030
Phone: +86 21 6487 9611
Fax: +86 21 6438 7110
info@krohne-asia.com

Czech Republic

Soběšická 156
63800 Brno
Phone: +420 [0]545.242.627
Fax: +420 [0]545 220 093
brno@krohne.cz

France

KROHNE S.A.S.
Les Ors BP 98
F-26103 ROMANS Cedex
Phone: +33 [0]4 75 05 44 00
Fax: +33 [0]4 75 05 00 48
info@krohne.fr

Great Britain

KROHNE Ltd.
Rutherford Drive
Park Farm Industrial Estate
Wellingborough
Northants NN8 6AE
Phone: +44 [0]19 33 408 500
Fax: +44 [0]19 33 408 501
info@krohne.co.uk

CIS

Kanex KROHNE Engineering AG
Business-Centre Planeta
Office 404 ul.
Marxistskaja 3
109147 Moscow/Russia
Phone: +7 [0]095 911 7165
Fax: +7 [0]095 742 8873
krohne@dot.ru

India

Krohne Marshall Ltd.
A-34/35, M.I.D.C. Industrial Area,
H-Block
Pimpri Poona 411018
Phone: +91 [0]202 744 2020
Fax: +91 [0]202 744 2020
pcu@vsnl.net

Iran

KROHNE Liaison Office
North Sohrvardi Ave. 26,
Sarmad St., Apt. #9
Tehran 15539
Phone: +9821 8874 5973
Fax: +9821 8850 1268
krohne@krohneiran.com

Italy

KROHNE Italia Srl.
Via V. Monti 75
I-20145 Milan
Phone: +39 02 4300 661
Fax: +39 02 4300 6666
info@krohne.it

Korea

KROHNE Korea
Room 508 Miwon Bldg 43
Yoido-Dong Youngdeungpo-Ku
Seoul, Korea
Phone: 00-82-2-782-1900
Fax: 00-82-2-780-1749
krohnekorea@krohnekorea.com

Netherlands

KROHNE Nederland B.V.
Kerkeplaat 14
NL-3313 LC Dordrecht
Phone: +31 [0]178 630 6200
Fax: +31 [0]178 630 6405
Service Direct: +31 [0]178 630 6222
info@krohne.nl

Norway

KROHNE Norway A.S.
Ekholtveien 114
NO-1521 Moss
Phone: +47 [0]69 264 860
Fax: +47 [0]69 267 333
postmaster@krohne.no

Poland

KROHNE Endra Sp.z.o.o.
ul. Stary Rynek Otiwskiego 8a
80-324 Gdansk
Phone: +48 [0]58 520 9211
Fax: +48 [0]58 520 9212
wendraszka@krohne.pl

Switzerland

KROHNE AG
Uferstr. 90
CH-4019 Basel
Phone: +41 [0]61 638 30 30
Fax: +41 [0]61 638 30 40
info@krohne.ch

Singapore

Tokyo Keiso - KROHNE (Singapore)
Pte. Ltd.
14, International Business Park,
Jurong East
Chiyoda Building, #01-01/02
Singapore 609922
Phone: (65) 6567 4548
Fax: (65) 6567 9874
tks@tokyokeiso-krohne.com.sg

Republic of South Africa

KROHNE Pty. Ltd.
163 New Road
Halfway House Ext 13
Midrand
Phone: +27 [0]11 315 2685
Fax: +27 [0]11 805 0531
midrand@krohne.co.za

Spain

I.I. KROHNE IBERIA, S.r.l.
Poligono Industrial Nito
Calle Brasil, nº. 5
28806 Alcalá de Henares Madrid
Phone: +34 [0]91 883 2152
Fax: +34 [0]91 883 4854
krohne@krohne.es

USA

KROHNE, Inc.
7 Dearborn Road
Peabody, MA 01960
Phone: +1 [800] FLOWING
Phone: +1 [978] 535 6060 (in MA)
info@krohne.com

Representatives

Algeria
Argentina
Cameroun
Canada
Chile
Columbia
Croatia
Denmark
Ecuador
Egypt
Finland
Gabon
Ghana
Greece
Hong Kong
Hungary
Indonesia
Iran
Ireland
Israel
Ivory Coast
Japan
Jordan
Kuwait
Libya
Lithuania
Malaysia
Mauritius
Mexico
Morocco
New Zealand
Peru
Portugal
Romania
Saudi Arabia
Senegal
Slovakia
Slovenia
Sweden
Taiwan
Thailand
Tunisia
Turkey
Venezuela
Yugoslavia

Other countries

KROHNE Messtechnik GmbH & Co. KG
Ludwig-Krohne-Str. 5
D-47058 Duisburg
Phone: +49 [0]203 301 0
Fax: +49 [0]203 301 389
export@krohne.de